

## Equality Impact Assessment Corporate Assessment Template



**Project: Churchlands South Phase 1A CO16296**

**New TROs on new highway:**

**Who is responsible for developing and implementing the Project?**

Name: [REDACTED]	Job Title: Section Leader Road Safety and Technical Standards
Service Team: S278 / S38	Service Area: Planning, Transport, Environment, Transport Planning Policy & Strategy
Assessment Date: 11/01/2022	

### 1. What are the objectives of the Project?

**To enable the efficient operation of the Public Highway with reference to the Hierarchy of users as established in the Welsh Government's Active Travel Act and related documents.**

**In particular this will involve ensuring an efficient bus service as part of the modal share aims incorporated in the design of the scheme.**

**Many of these aims were established as part of the Planning Consent and have to be delivered through the S278 Agreement process.**

### 2. Please provide background information on the Project and any research done [e.g. service users data against demographic statistics, similar EIAs done etc.]

**The project is to fulfil requirements of the relevant Planning Consent and these matters are not able to be revisited as part of the S278 Agreement processes. If required, reference should be made to the Planning File.**

### 3 Assess Impact on the Protected Characteristics

#### 3.1 Age

Will this Project have a **differential impact [positive/negative/]** on younger/older people?

	Yes	No	N/A
Up to 18 years	+ve		
18 - 65 years	+ve		

# CARDIFF COUNCIL

## Equality Impact Assessment Corporate Assessment Template

Over 65 years	+ve		
---------------	-----	--	--

**Please give details/consequences of the differential impact, and provide supporting evidence, if any.**

This will apply to all vehicle users equally, except that users of Active and non-private transport will be benefited. Consequently, non-drivers tend to be more represented in younger and older groups and so measures to support the user Hierarchy will tend to benefit those age groups in preference to the central age group.

**What action(s) can you take to address the differential impact?**

None required.

### 3.2 Disability

Will this Project have a **differential impact [positive/negative]** on disabled people?

	Yes	No	N/A
Hearing Impairment		No	
Physical Impairment	+ve		
Visual Impairment	+ve		
Learning Disability	+ve		
Long-Standing Illness or Health Condition	+ve		
Mental Health	+ve		
Substance Misuse		No	
Other		No	

**Please give details/consequences of the differential impact, and provide supporting evidence, if any.**

This will apply to all vehicle users equally, except the benefits towards non-drivers. There may be minor benefits to some groups by facilitating access to the bus stops and ensuring visibility at the crossing points.

**What action(s) can you take to address the differential impact?**

None required.

### 3.3 Gender Reassignment

Will this Project have a **differential impact [positive/negative]** on transgender people?

	Yes	No	N/A
<b>Transgender People</b> (People who are proposing to undergo, are undergoing, or have		No	

# CARDIFF COUNCIL

## Equality Impact Assessment Corporate Assessment Template

undergone a process [or part of a process] to reassign their sex by changing physiological or other attributes of sex)			
--	--	--	--

**Please give details/consequences of the differential impact, and provide supporting evidence, if any.**

This will apply to all users equally, within all modes of travel.

**What action(s) can you take to address the differential impact?**

None required.

### 3.4. Marriage and Civil Partnership

Will this Project have a **differential impact [positive/negative]** on marriage and civil partnership?

	Yes	No	N/A
Marriage		No	
Civil Partnership		No	

**Please give details/consequences of the differential impact, and provide supporting evidence, if any.**

This will apply to all users equally, within all modes of travel.

**What action(s) can you take to address the differential impact?**

None required.

### 3.5 Pregnancy and Maternity

Will this Project have a **differential impact [positive/negative]** on pregnancy and maternity?

	Yes	No	N/A
Pregnancy	+ve		
Maternity	+ve		

**Please give details/consequences of the differential impact, and provide supporting evidence, if any.**

The benefits for non-private transport will benefit these groups who tend to be under represented amongst car owners and drivers compared to the average population.

**What action(s) can you take to address the differential impact?**

## CARDIFF COUNCIL

### Equality Impact Assessment Corporate Assessment Template

None required.

#### 3.6 Race

Will this Project have a **differential impact [positive/negative]** on the following groups?

	Yes	No	N/A
White		No	
Mixed / Multiple Ethnic Groups		No	
Asian / Asian British		No	
Black / African / Caribbean / Black British		No	
Other Ethnic Groups		No	

**Please give details/consequences of the differential impact, and provide supporting evidence, if any.**

This will apply to all users equally, within any mode of travel.

**What action(s) can you take to address the differential impact?**

None required.

#### 3.7 Religion, Belief or Non-Belief

Will this Project have a **differential impact [positive/negative]** on people with different religions, beliefs or non-beliefs?

	Yes	No	N/A
Buddhist			N/A
Christian			N/A
Hindu			N/A
Humanist			N/A
Jewish			N/A
Muslim			N/A
Sikh			N/A
Other			N/A

**Please give details/consequences of the differential impact, and provide supporting evidence, if any.**

This will apply to all users equally, within any mode of travel.

**What action(s) can you take to address the differential impact?**

## CARDIFF COUNCIL

### Equality Impact Assessment Corporate Assessment Template

None required.

#### 3.8 Sex

Will this Project have a **differential impact [positive/negative]** on men and/or women?

	Yes	No	N/A
Men	Yes		
Women	Yes		

**Please give details/consequences of the differential impact, and provide supporting evidence, if any.**

As women tend to be more represented in the users that are higher in the Hierarchy of users, measures that benefit pedestrians and public transport compared to the private car will benefit them to a minor detriment to men. But there is no differential impact on men and women for the same modes of transport.

**What action(s) can you take to address the differential impact?**

None as this is an outcome from the Hierarchy of users and socio-economic factors at a national level.

#### 3.9 Sexual Orientation

Will this Project have a **differential impact [positive/negative]** on the following groups?

	Yes	No	N/A
Bisexual		No	
Gay Men		No	
Gay Women/Lesbians		No	
Heterosexual/Straight		No	

**Please give details/consequences of the differential impact, and provide supporting evidence, if any.**

This will apply to all users equally, within any mode of travel.

**What action(s) can you take to address the differential impact?**

None required.

#### 3.10 Socio-economic Duty

# CARDIFF COUNCIL

## Equality Impact Assessment Corporate Assessment Template

Will this Project have a **differential impact [positive/negative]** on the Socio-economic Duty?

	Yes	No	N/A
		No	

**Please give details/consequences of the differential impact, and provide supporting evidence, if any.**

This will apply to all users equally, within any mode of travel.

**What action(s) can you take to address the differential impact?**

None required.

### 3.11 Welsh Language

Will this Project have a **differential impact [positive/negative]** on Welsh Language?

	Yes	No	N/A
		No	

**Please give details/ consequences of the differential impact, and provide supporting evidence, if any.**

All signs to be bilingual in accordance with the Welsh Language Act

**What action(s) can you take to address the differential impact?**

None required.

### 4. Consultation and Engagement

What arrangements have been made to consult/engage with the various Equalities Groups?

None as this project is part of the implementation of a planning consent and there is no scope to review it as part of the Traffic Regulation Order process.

### 5. Summary of Actions [Listed in the Sections above]

Groups	Actions
Age	None as the proposals benefit this cohort.

## CARDIFF COUNCIL

### Equality Impact Assessment Corporate Assessment Template

Disability	<b>None as the proposals benefit this cohort.</b>
Gender Reassignment	<b>None</b>
Marriage & Civil Partnership	<b>None</b>
Pregnancy & Maternity	<b>None as the proposals benefit this cohort.</b>
Race	<b>None</b>
Religion/Belief	<b>None</b>
Sex	<b>None</b>
Sexual Orientation	<b>None</b>
Socio-economic Duty	<b>None</b>
Welsh Language	<b>None</b>
Generic Over-Arching [applicable to all the above groups]	<b>None as the proposals benefit all users.</b>

#### 6. Further Action

Any recommendations for action that you plan to take as a result of this Equality Impact Assessment (listed in Summary of Actions) should be included as part of your Service Area's Business Plan to be monitored on a regular basis.

#### 7. Authorisation

The Template should be completed by the Lead Officer of the identified Policy/Strategy/Project/Function and approved by the appropriate Manager in each Service Area.

Completed By : [REDACTED]	Date: 11/01/2022
Designation: Section Leader	
Approved By: [REDACTED]	
Designation: Principal Engineer Section 278 and Section 38 Approvals	
Service Area: Planning Transportation and Environment	

- 7.1 On completion of this Assessment, please ensure that the Form is posted on your Directorate's Page on CIS - *Council Wide/Management Systems/Equality Impact Assessments* - so that there is a record of all assessments undertaken in the Council.

For further information or assistance, please contact the Citizen Focus Team [REDACTED]  
[REDACTED]



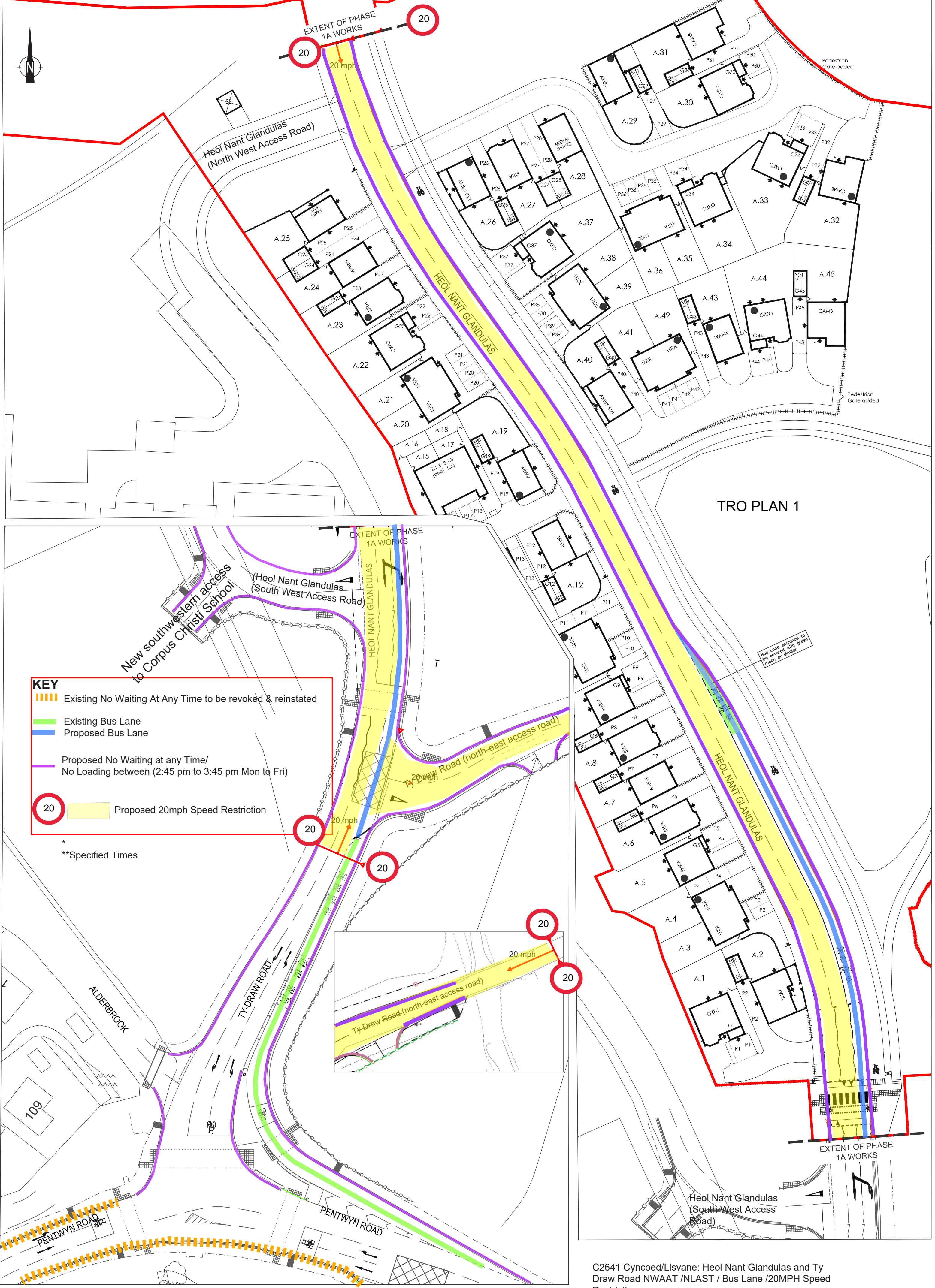

TRO PLAN 1



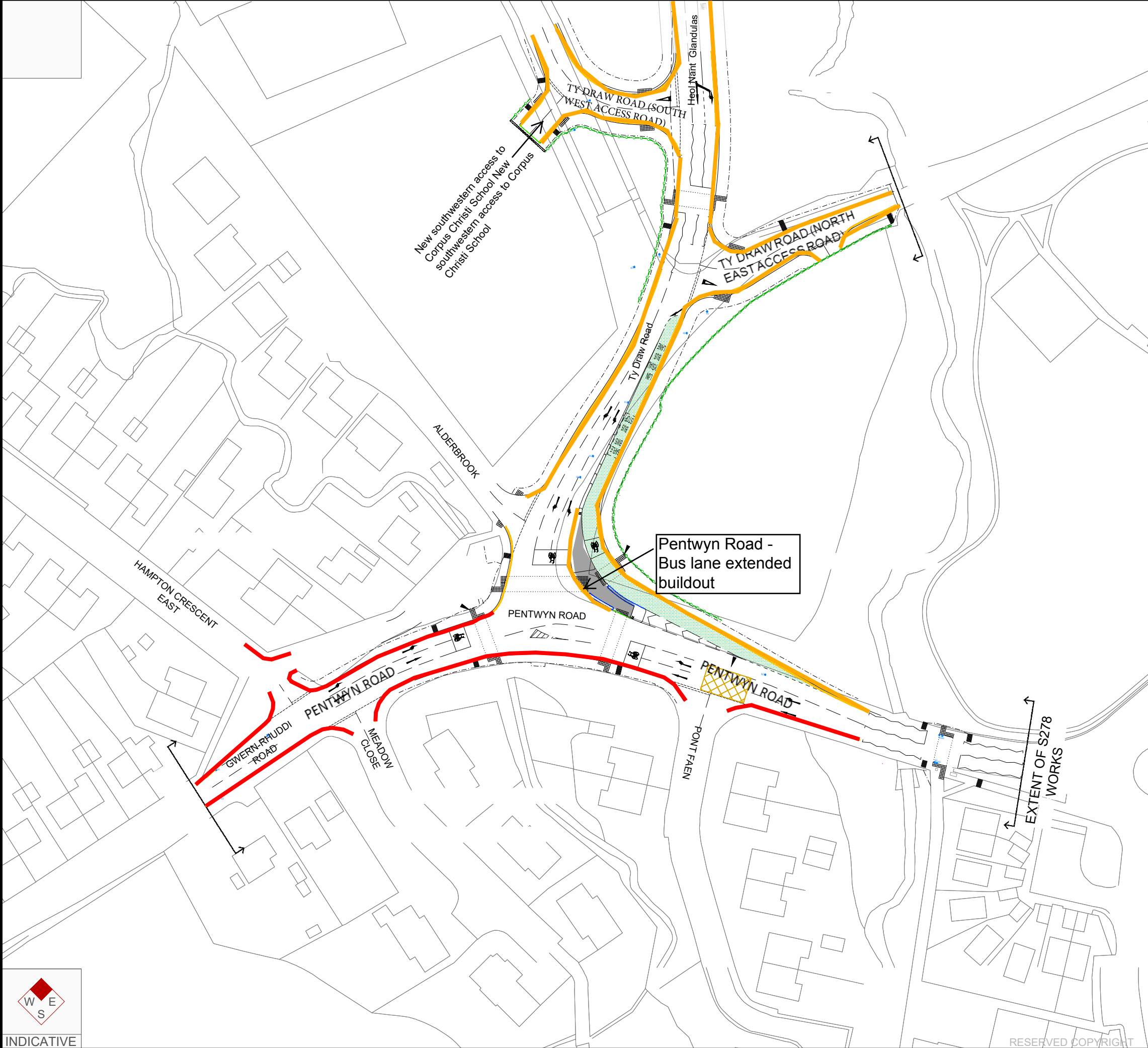

Reproduced from Ordnance Survey Superplan Data with the permission of The Controller of Her Majesty's Stationery Office. Crown Copyright - Licence No. AL100034021

NOTES:

Existing Orders

No Waiting At Any Time to be revoked and reinstated 

Bus Lane 

Proposed Order

Revoke the existing No Waiting at any Time to proposed No Waiting at any Time/  
No Loading between (2:45 pm to 3:45 pm Mon to Fri) 

Miscellaneous

Bus lane extended buildout 

Cyncoed/Lisvane: Heol Nant Glandulas and Ty Draw Road NWAAT / NLAST / Bus Lane /20MPH Speed Restriction

TRO PLAN 2

SCALE: 1:1000	DATE: 09/5/22			
DRAWING NO: TRO			REVISION: A	



INDICATIVE

RESERVED COPYRIGHT







